



1063 Majaun Dr. | Lexington, KY



**Square Feet:** 9,600

**Acres:** 0.99

**Zoning:** I-1 office/warehouse

**Sale Price:** \$565,000

**Building Built:** 1976

**Physical Highlights:**

On-site Amenities:

- 1 drive-in door
- 1 loading dock that will accommodate 53' trailers
- 16' ceiling height in warehouse
- Exterior storage area

Area Amenities:

- Easy access to New Circle, & only 1.5 miles to I-75 and I-64

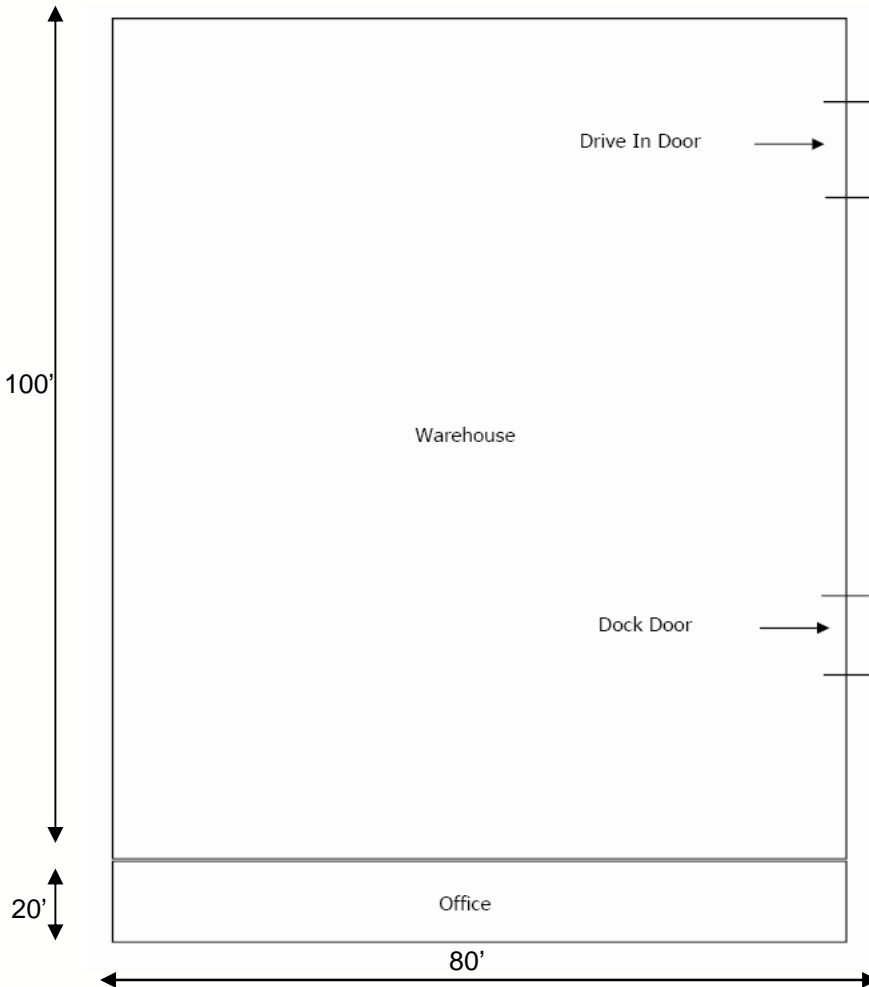

Excellent visibility & access from Georgetown Rd. 8,000 square feet of warehouse space & 1,600 square feet of office. Loading dock accommodates 53' trailers, 1 drive-in door, 16' ceiling height in warehouse, & easy access to I-75/I-64.

**Amy Mellinger**  
 (859) 619-5369 (cell)  
 (859) 293-1111 (office)  
 amy@fortunerealty.com

900 Beasley Street • Suite 110 • Lexington, KY 40509

**FortuneRealty.com**



**John Paul Miller**  
 (859) 293-1111 (office)  
 jp@fortunerealty.com



**1063 Majaun Rd.**

Easy access to I-75/I-64, New Circle Rd. (RT4), Newtown Pike (HWY 922), and Georgetown Rd. (US 25).

**Newtown Pike Traffic Count:**

**New Circle to Nandino Road**  
31,700 cars per day (2007)

**Nandino Road to I-75**  
44,500 cars per day (2007)

**New Circle:**  
62,000 cars per day (2007)

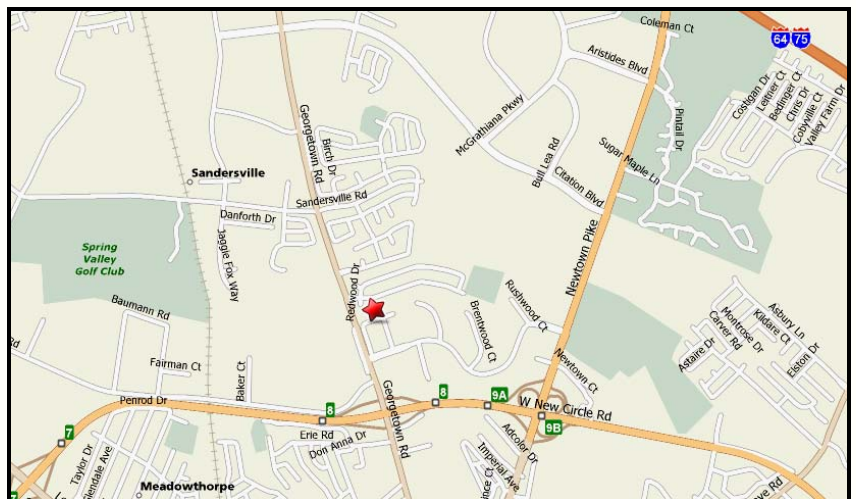

**Amy Mellinger**  
(859) 619-5369 (cell)  
(859) 293-1111 (office)  
amy@fortunerealty.com

900 Beasley Street • Suite 110 • Lexington, KY 40509



**John Paul Miller**  
(859) 293-1111 (office)  
jp@fortunerealty.com



8,000 SF Warehouse  
1,600 SF Office Space  

---

9,600 SF Total Space

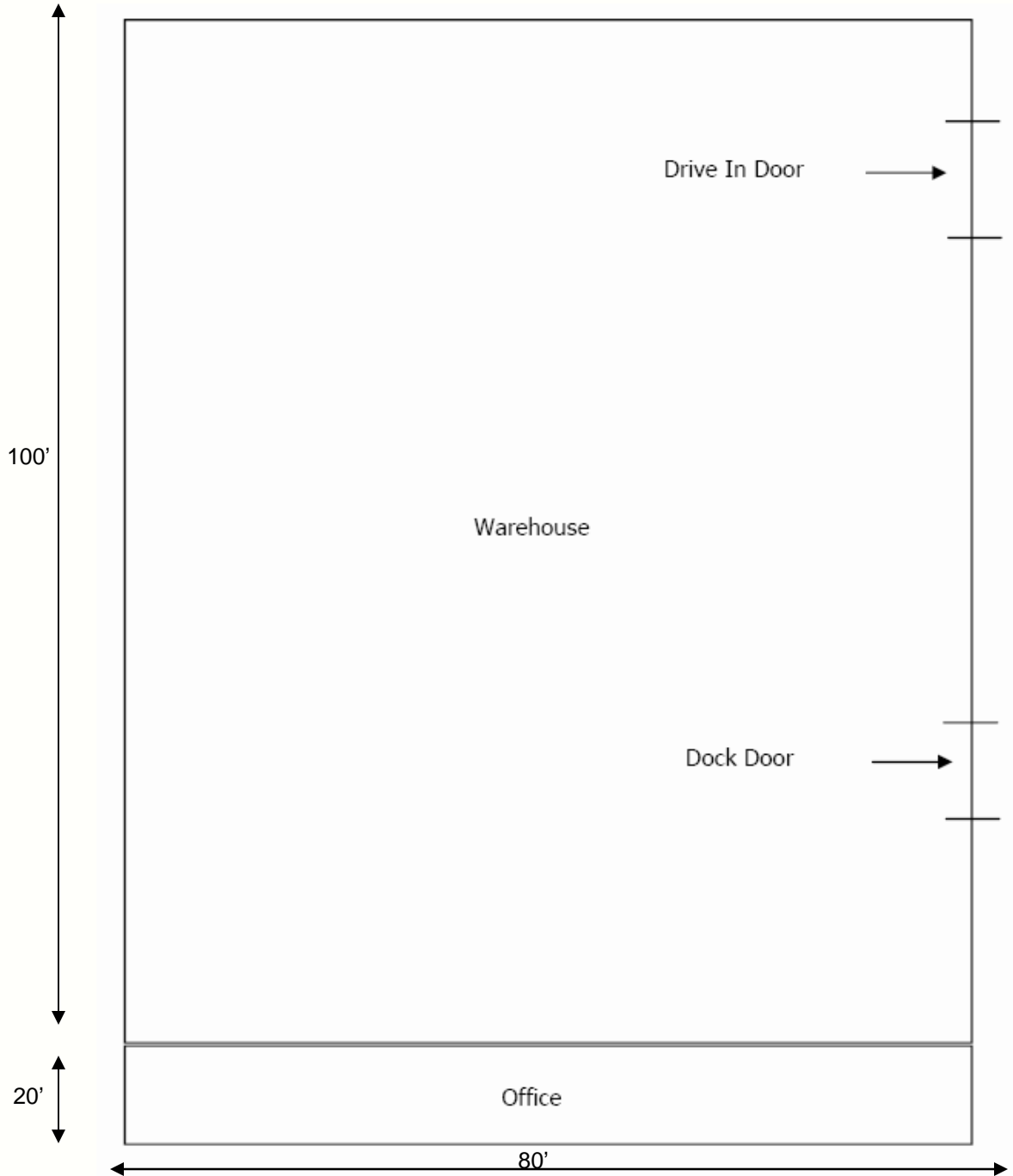

**Amy Mellinger**  
(859) 619-5369 (cell)  
(859) 293-1111 (office)  
amy@fortunerealty.com

900 Beasley Street • Suite 110 • Lexington, KY 40509

**FortuneRealty.com**



**John Paul Miller**  
(859) 293-1111 (office)  
jp@fortunerealty.com